



**MODULAR  
BUILDING  
SYSTEMS**

**LOGISTIC  
EQUIPMENTS**  
**TECHNICAL  
SHELTERS**

ITALY: HEAD OFFICE

Via Surbo 38 - 73019  
TREPUIZZI - LE  
Tel e Fax:  
+39 0832 758225  
info@ricopre.it  
www.rigroup.it

**CENTRO DIAGNOSTICO  
MALATTIE INFETTIVE**



Personal Protective Equipment

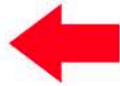

**6**

VISIT BY SPECIALIST DOCTORS DRESSED IN WHITE ANTI-CONTAGION PROTECTIVE SUITS FACE MASK, EYES PROTECTION, GLOVES, SHOE COVER

**7** **8**

THERAPY KICK OFF THROUGH HYDRATION, EXPERIMENTAL DRUGS AND BLOOD INFUSIONS

IF THE PATIENT REACTS WELL TO THE TREATMENT, HE IS DISCHARGED AFTER THREE WEEKS (THE VIRUS IS FINALLY DEAD)

**5**

HOSPITALIZATION IN AN ASEPTIC ROOM (INSIDE JUST A BED, SMALL TABLE AND A CABINET)

**4**

WHEN THE TEST IS POSITIVE, THE PATIENT IS TRANSPORTED TO AN ISOLATED UNIT (INFECTIOUS PATIENT ROUTE IS CLOSED TO THE REST OF MEDICAL PERSONNEL)

**3**

ORAL SWAB WITH STICK BY DOCTORS WITH ANTI-CONTAGION SUITS, FACE AND EYES MASKS, GLOVES AND SHOE COVER

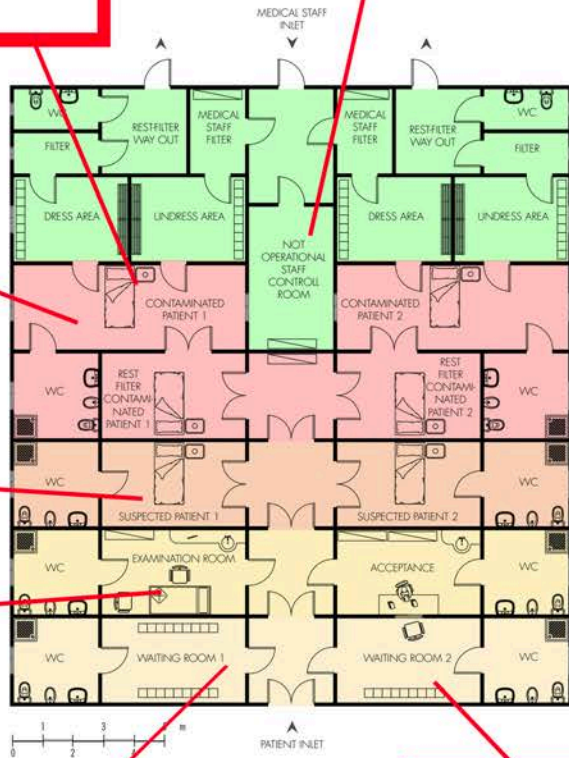

**2**

SEPARATE ENTRANCE IN A FULLY STERILIZED ROOM

**1**

ARRIVAL TO THE TRIAGE AND DESCRIPTION THROUGH THE INTERCOM THE SYMPTOMS AND PLACES VISITED IN THE LAST 21 DAYS

The Testing Process



MODULAR MEDICAL INFECTIOUS DISEASES

DIAGNOSTIC CENTRE



GROUP

WWW.RIGROUP.IT